

GK15312GP

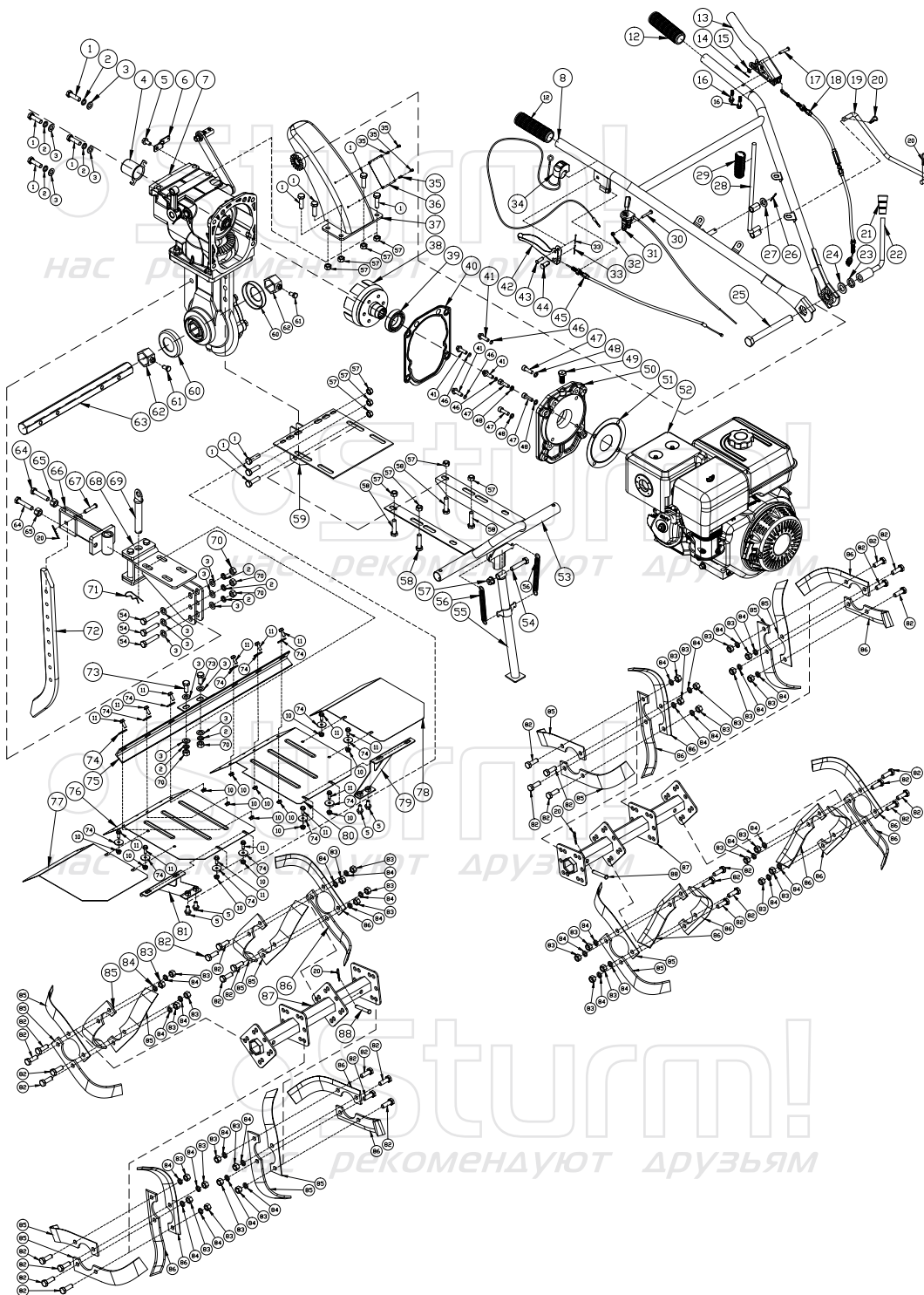

NO.	DESCRIPTION	NO.	DESCRIPTION
1	BOLT M10×35	46	O-RING
2	SPRING WASHER Φ10	47	BOLT M8X25
3	WASHER Φ10	48	SPRING WASHER Φ8
4	SPINDLE GUARD	49	PRESSURE RELIEF BOLT
5	BOLT M8×16	50	FLANGE PLATE
6	CLUTCH CABLE BLOCK	51	GASKET
7	TRANSMISSION BOX ASSY.	52	GASOLINE ENGINE
8	HANDLE FRAME	53	BUMPER SUPPORT
10	NUT M6	54	BOLT M10X50
11	BOLT M6×16	55	FRONT SUPPORT
12	HANDLE SLEEVE	56	TENSION SPRING
13	CLUTCH HANDLE	57	NUT M10
14	SPRING PIN	58	BOLT M10X40
15	WASHER Φ6	59	ENGINE SUPPORT
16	BOLT M6×30	60	DUST COVER
17	PIN Φ6X30	61	BOLT M8X16
18	CLUTCH CABLE	62	HEXAGONAL FIXING SLEEVE
19	GEAR SHIFTING CONNECTION ROD	63	HEXAGONAL OUTPUT SHAFT
20	SPRING PIN	64	BOLT M12X50
21	LOCKING HANDLE SLEEVE	65	NUT M12
22	LOCKING HANDLE	66	CONNECTOR ASSEMBLY
23	SPRING WASHER Φ16	67	PIN Φ8X40
24	WASHER Φ16	68	TRAILER BODDY ASSEMBLY
25	BOLT M16X150	69	BIG PIN
26	SPRING PIN	70	NUT M10
27	WASHER Φ12	71	SPRING PIN
28	GEAR SHIFTING CONTROL ROD	72	RESISTANCE BAR
29	GEAR SHIFTING CONTROL ROD HANDLE	73	BOLT M10X25
30	SCREW M5X30	74	WASHER Φ6
31	THROTTLE SWITCH	75	FENDER REAR BRACKET
32	NUT M5	76	RIGHT FENDER
33	SPRING PIN	77	RIGHT SAMLL FENDER
34	STOP SWITCH CABLE	78	LEFT SAMLL FENDER
35	RIVET Φ3,2X9	79	RIGHT FENDER FRONT BRACKET
36	LABEL	80	LEFT FENDER
37	HANDLE STAND	81	LEFT FENDER FRONT BRACKET
38	CLUTCH HOUSING	82	BOLT M10X30
39	BEARING 6007	83	NUT M10
40	GASKET	84	SPRING WASHER Φ10
41	BOLT M8X25	85	RIGHT BLADE
42	REVERSE HANDLE	86	LEFT BLADE
43	PIN Φ7X22	87	BLADE SPINDLE
44	PIN Φ10X22	88	PIN Φ8X50
45	REVERSE HANDLE CABLE		

ENGINE FOR GK15312GP

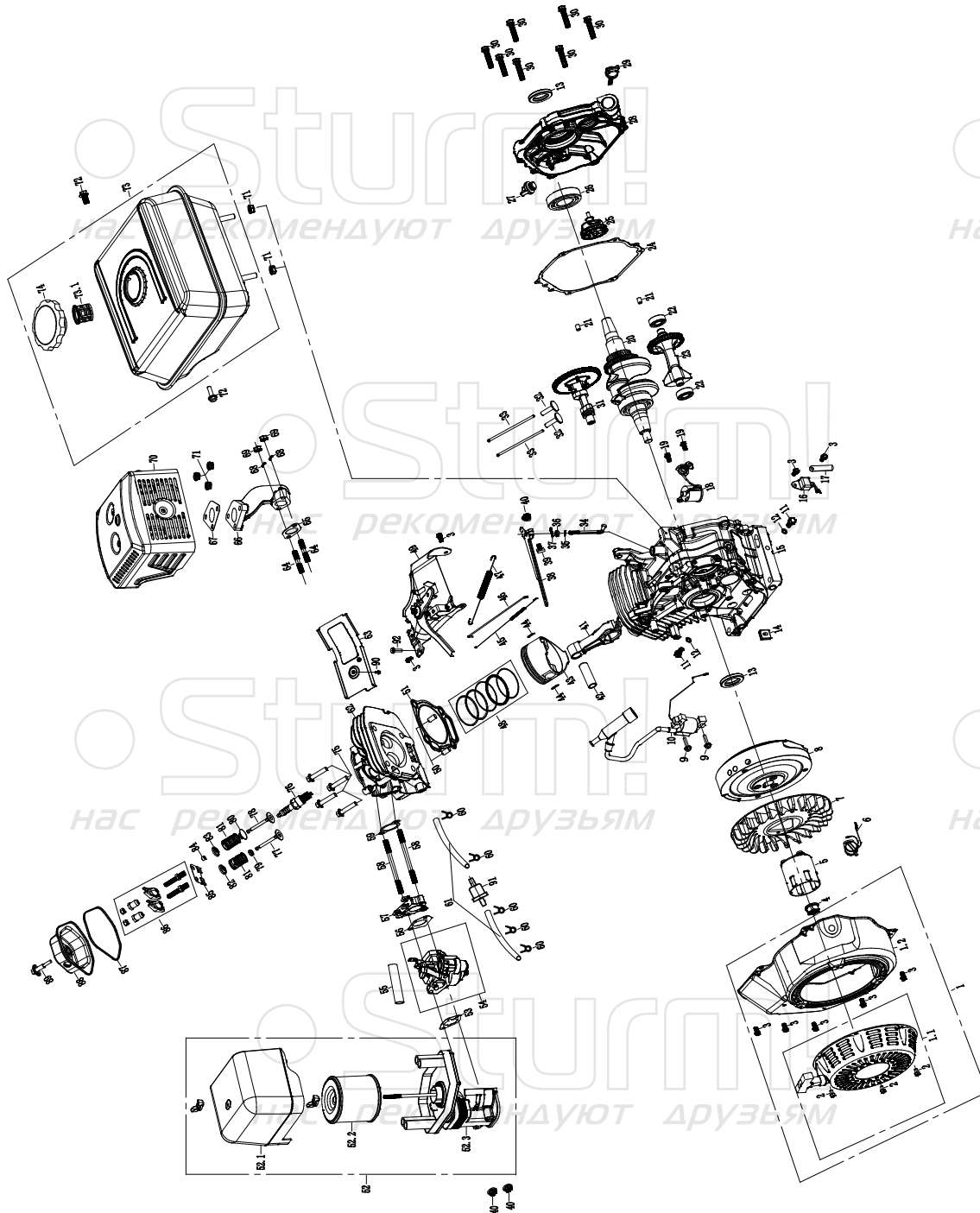

NO.	DESCRIPTION	NO.	DESCRIPTION
1	RECOIL STARTER ASSY	49	SPEED CONTROL
1-1	STARTER	50	PIN $\Phi 12 \times 20$
1-2	COVER FAN	51	CYLINDER HEAD GASKET
2	BOLT M6 \times 8	52	AIR FILTER
3	BOLT M6 \times 12	52-1	AIR FILTER COVER
4	NUT M16 \times 1.5	52-2	FILTER
5	STARTER CUP	52-3	AIR FILTER SEAT
6	SWITCH	53	AIR FILTER GASKET
7	FAN	54	CARBURETOR
8	FLY WHEEL	55	BREATH PIPE
9	BOLT M6 \times 25	56	CARBURETOR GASKET
10	IGNITION	57	BLOCK BOARD
11	BOLT M12 \times 1.5 \times 15	58	DOUBLE BOLT
12	WASHER $\Phi 20 \times \Phi 12 \times 1.5$	59	GASKET
13	OIL SEAL	60	CLIP
14	THREADING BLOCK	61	FUEL PIPE
15	CRANK BOX	62	CYLINDER HEAD
16	SEPARATOR	63	COOL GUIDE BOARD
17	WIRE CLAMP	64	DOUBLE BOLT
18	OIL ALARM	65	MUFFLER GASKET
19	BOLT M6 \times 16	66	EXHAUST PIPE
20	CRANK SHAFT	67	EXHAUST PIPE GASKET
21	PIN $\Phi 8 \times 14$	68	SPRING WASHER $\Phi 8$
22	BEARING 6202	69	NUT M8
23	BALANCE SHAFT	70	MUFFLER
24	CRANK BOX GASKET	71	NUT M8
25	REFE-LIMITING GEAR ASSY	72	BOLT M8 \times 25
26	BEARING 6207	73	FUEL TANK
27	OIL PLUG	73-1	FUEL FILTER
28	CRANK BOX COVER	74	FUEL TANK CAP
29	OIL GAUGE	75	BOLT M10 \times 1.25 \times 80
30	BOLT M8 \times 40	76	SPARK PLUG
31	CAMSHAFT	77	INTAKE VALVE
32	ROD	78	EXHAUST VALVE
33	PUSH ROD	79	VALVE OIL SEAL
34	SWINGING ROD	80	LOWER VALVE SEAT
35	WASHER $\Phi 8$	81	VLAVE SPRING
36	OIL SEAL	82	INTAKE VALVE SPRING BASE
37	SPRING PIN	83	EXHAUST VALVE SPRING BASE
38	CONTROL ARM	84	TOP COVER
39	T-BOLT M6 \times 21	85	GUIDE BOARD
40	NUT M6	86	ROCK ARM ASSY.
41	CONNECT ROD	87	CYLINDER HEAD GASKET
42	PISTON PIN	88	CYLINDER HEAD COVER
43	PISTON	89	BOLT M6 \times 60
44	PISTON PIN CIRCLIP	90	BOLT M6 \times 12
45	SMALL TENSION SPRING	91	FUEL PIPE FILTER
46	SPEED CONTROL LEVER	92	BOLT M6 \times 20
47	BIG TENSION SPRING		
48	PISTON RING ASSY		